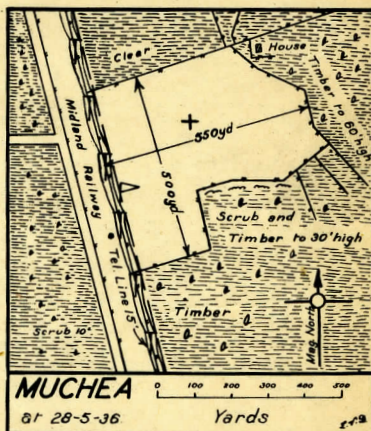
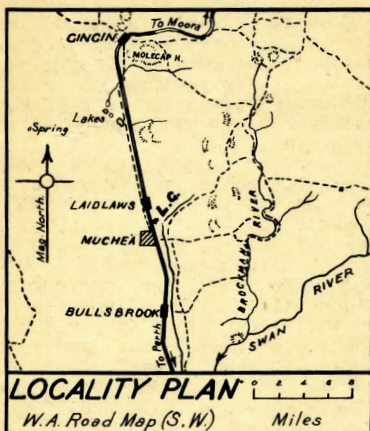

NOTICE TO AIRMEN

(CANCELS No. 3/1925)

NO. 12/1937
MUCHEA, W.A.

CLASS OF GROUND: Emergency Landing Ground.

PROPRIETORS: Civil Aviation Board, Melbourne.

POSITION: East of railway, two miles north of Muchea siding.

Lat: $31^{\circ} 33'$ S. Long $115^{\circ} 58'$ E.MAGNETIC VARIATION: $4\frac{1}{2}^{\circ}$ W. approx.

DISTINCTIVE FEATURES: Railway adjoins to west; homestead at N.E. corner of landing ground.

MARKINGS: White cross and wind indicator.

DESCRIPTION: Surface in good condition.

DIMENSIONS: North - South, 500 yards. East - West, 550 yards.

HEIGHT ABOVE SEA LEVEL: About 170 feet.

APPROACHES: North, clear. South, scrub and timber, 30 ft. high.

East, timber, 60 ft. high. West, railway and telegraph.

SURROUNDING COUNTRY: Scrubby, unsuitable for forced landings.

PETROL AND OIL: Muchea, two miles south.

WATER SUPPLY: At adjacent homestead.

WORKSHOPS: Midland Junction, 23 miles south.

HANGAR ACCOMMODATION: Nil at present.

TELEPHONE AND TELEGRAPH: Muchea P.O.

NEAREST TOWN: Muchea.

RAILWAY STATION: Muchea.

CHARGES: Nil at present.

REMARKS: Stock are frequently grazed on area.

Strip maps Nos. 18 and 53.

S. A. Crawford
Secretary,
Civil Aviation Board.