

CIVIL AVIATION DEPARTMENT

AUSTRALIA

DATA SHEET FOR  
(REVISED - MAR. 1940)

LANDING GROUND NO. 308  
NORTHAMPTON DOWNS, QLD.

LICENSED AERODROME - B CLASS

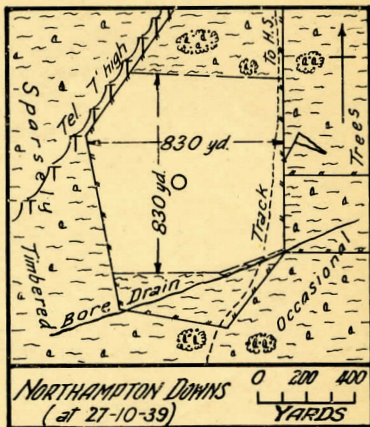
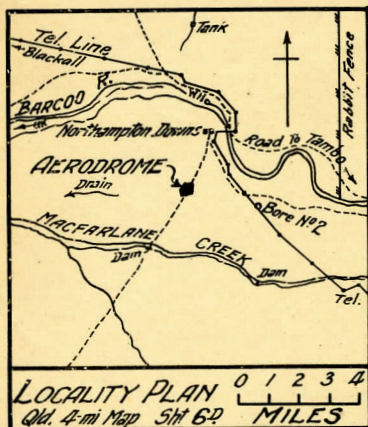

LATITUDE:  $24^{\circ} 36' S$ ; LONGITUDE:  $145^{\circ} 46' E$ ; MAG. VAR:  $6\frac{1}{2}^{\circ} E$   
ALTITUDE: 1060 feet approx.  
POSITION: Approximately 2 miles SSW of Homestead, between Barcoo River and Macfarlane Creek.  
RELEVANT AVIATION MAPS: Mercator sheet G.8. Stripmaps Nos. 39 and 57.  
SURROUNDING COUNTRY: Scattered timber with open parts suitable for forced landings.  
LANDMARKS: Tel. line (7 ft.) along NW of ground, bore drain along southern portion and track to Northampton Downs Station along eastern side of ground.  
APPROACHES: Surrounded by scattered trees, 7 ft. tel. line on NW and fences on E and W sides.  
MARKINGS: White circle and wind indicator.  
DIMENSIONS: N-S, 830 yards; E-W, 830 yards.  
SURFACE: Good.

TOWN and RAILWAY STATION: Blackall, 26 miles.  
TELEPHONE: At Homestead, 2 miles.  
REFUELLING: Limited supplies at Homestead and bulk supplies at Blackall.  
REPAIRS: At Homestead and Blackall.  
WATER: Bore drain along S boundary.

PROPRIETORS: Rubin Bros., Northampton Downs, via Blackall, Qld.  
CHARGES: Nil at present.

REMARKS: Ground unsuitable for use after continuous rain.

A. B. CORBETT

Z-757 P.1631

Director-General of Civil Aviation.