

CIVIL AVIATION BRANCH DEPARTMENT OF DEFENCE AUSTRALIA  
NOTICE TO AIRMEN. NO. 35/1929.

(REVISED 1935) PONT'S SPRINGS PLAINS, W.A.

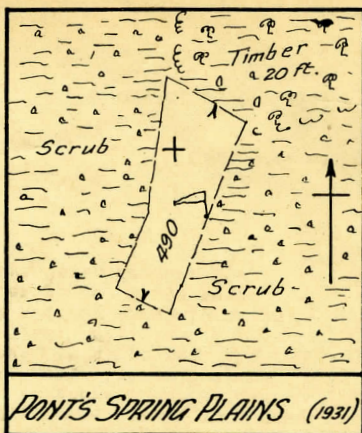

CLASS OF GROUND: Emergency Landing Ground.  
PROPRIETORS: Commonwealth of Australia (Controller of Civil Aviation, Melbourne).  
POSITION: Lat. 18°30'S. Long. 126°35'E.  
MAGNETIC VARIATION: 2½° E. approx.  
DISTINCTIVE FEATURES: On North side of track to Louisa Downs Station, about ¾ mile South of Overland Telegraph Line.  
MARKINGS: White cross and wind indicator.  
DESCRIPTION: Good hard surface of ironstone gravel. Suitable all weather.  
DIMENSIONS: N. - 490 yards.  
E. - W. 175 yards. (One-way ground).  
HEIGHT ABOVE SEA LEVEL: About 500 feet.  
APPROACHES: Over low scrub and ant hills all directions.  
SURROUNDING COUNTRY: Generally unsuitable for forced landings, but country improves to East.  
PETROL AND OIL: Louisa Downs Station, 20 miles East.  
WATER SUPPLY: Nearest sure supply at Louisa Downs Station.  
Water may be found in creek bed to North of ground.  
WORKSHOPS: Blacksmiths' tools at Louisa Downs.  
HANGAR ACCOMMODATION: Nil.  
TELEGRAPH: Fitzroy Crossing, 75 miles West; Hall's Creek, 118 miles East.  
NEAREST TOWN: Derby, 280 miles West.  
REMARKS: Relative Strip Map No. 56.

*E. Johnston*

CONTROLLER OF CIVIL AVIATION.